

! IMPORTANT

Read Before Beginning Installation:

- Do not join fixture lengths together on the floor and lift into place. This introduces significant forces on the joins and will damage the fixtures.
- All fixtures should be installed in accordance with national and local building and electrical codes.
- Leave the protective bag and care labels on the fixture during installation. Warranty is void if labels are removed before installation is complete.
- Endcaps and joiners are integral luminaire components. Do not remove them to change run layouts. Any attempted disassembly voids warranty.

🔧 TOOLS REQUIRED

Tools:

- Level
- Sharp Side Cutter
- Measuring Tool
- Wire Stripper / Knife
- Phillips Screwdriver
- 1/16" Allen Key

1 | INSTALL CEILING DRIVER ENCLOSURE

**Refer to Driver Enclosure Installation Documents
+ Row Configuration Document**

Install ceiling driver enclosure and aircraft cable suspension per appropriate ceiling type installation instructions – noting the fixture spacing and that the non-power suspension point is NOT the end suspension point.

2 | LEAVE AIRCRAFT CABLE FULL LENGTH

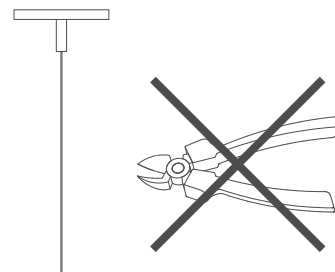

Do NOT trim the aircraft cable. The factory trimmed aircraft cable ends are required for insertion of the cable into the fixture cavity.

3 | LAY OUT LUMINAIRES

Refer to Row Configuration Document

Lay the fixture sections out to ensure the correct sections with ends and joints are supplied. Note that runs will have a Non-Power suspension point located one point in from the end of the run. Ensure fixture sections are laid out to match the Power suspension points that were prepared on the ceiling.

5 | LEVEL FIXTURE + TRIM AIRCRAFT CABLE

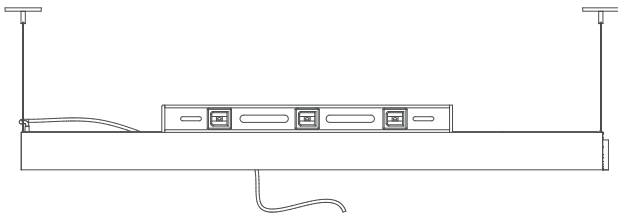

Adjust the height and level the fixture section. The aircraft cable gripper is released by pressing down on the gripper sleeve. **For Endcaps:** The excess aircraft cable will feed into an internal cavity in the fixture and does not need to be trimmed. **For Joints:** The excess aircraft cable needs to be routed back into the fixture. See Step #6. **If stand-alone fixture, go to step #10.**

7 | JOIN FIXTURES + LEVEL

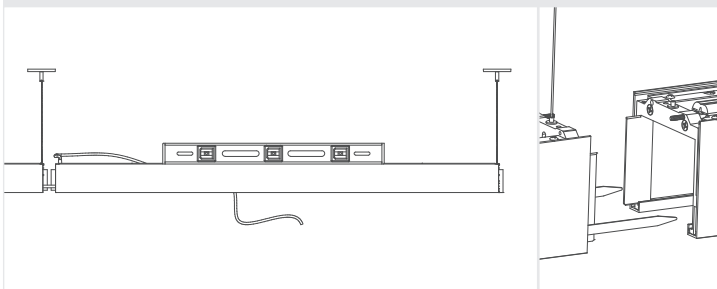

1. Lift the next fixture section into place and insert the one aircraft cable on the far end and join the other end to the previous fixture section by pressing the two fixtures together.
2. Level far end of the fixture by adjusting the aircraft cable in the gripper.

4 | LIFT INTO POSITION

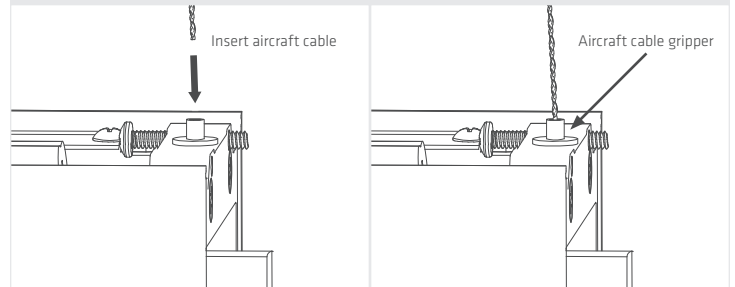

1. Lift first fixture section (or individual fixture if stand-alone) into place.
2. Insert the aircraft cables into both ends of the fixture mounts (aircraft cable gripper).

NOTE: For Drywall and Surface ceiling types, feed the aircraft cable through the canopy cover and threaded sleeve before inserting the cable into the fixture mount. Leave the protective bag on the fixture during installation.

6 | PREPARE JOIN

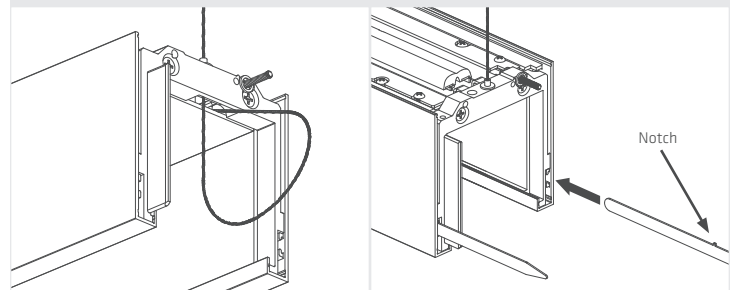

1. Feed all of the excess aircraft cable back into the fixture as shown.
2. Slide aligner pins into end of hanging fixture up to the notch.

8A | SECURE JOINS - STEP 1

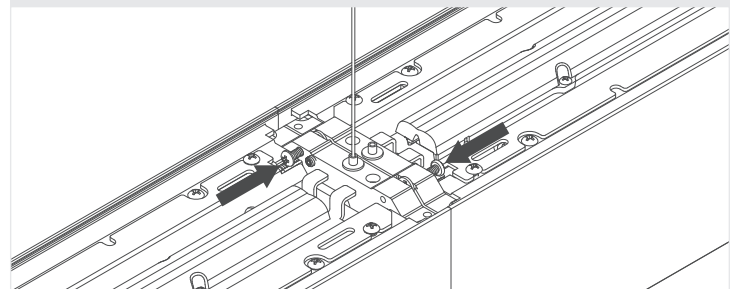

1. Push fixtures together and use a #1 Phillips screwdriver to tighten two top horizontal joining screws. Do not overtighten!

8B | SECURE JOINS - STEP 2

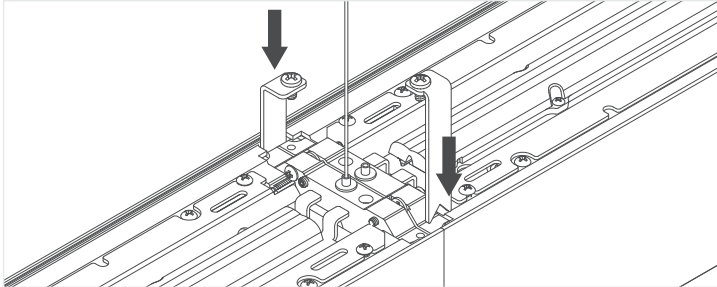

2. Insert two joining pins and using a Phillips screwdriver (Profile: #2, Profile Mini: #1), tighten until snug. The wedges on the joining pins ensure a tight connection between sections.
3. Repeat steps 6, 7 + 8 with each fixture section.

9 | INSTALL TRIM COVERS

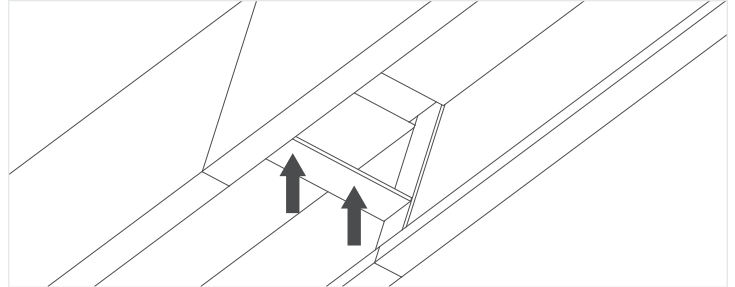

1. Ensure aircraft cable is tucked all the way in so trim cover will sit flat.
2. Push up on the center trim cover until the hidden magnets in the crossplate snap it into place.

10 | ATTACH POWER CORD

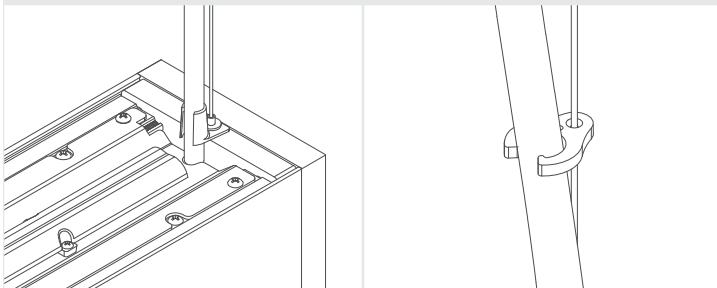

1. Clip the fixture end of cord into the cord restraint (not required on Profile Mini).
2. Lift low-voltage power cord up to ceiling box and attach cord clips.

11 | CONNECT TO J-BOX

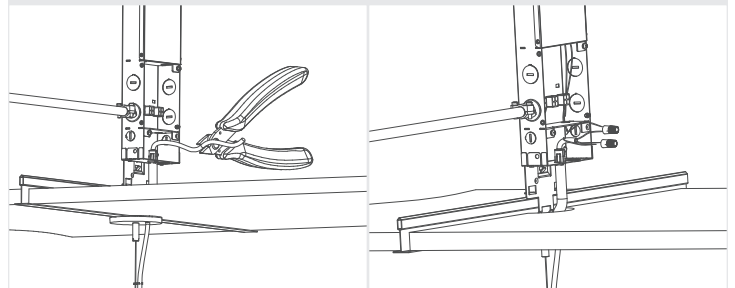

1. Determine the length of cord required.
2. Cut off the excess.
3. Strip the jacket and wires.
4. Connect to the blue and red wires in the low voltage junction box using supplied wire connectors.

NOTE: Depending on ceiling type, the canopy may need to be slid down the cord to complete the low voltage wiring.

NOTE:

For PF1, PF4-Area / PF2, PF5-VSI: 4 conductor cords have a red + blue stripe pair and a red + blue solid pair – ensure the pairs are maintained in junction box connections.

- The solid pair connects to the 4 foot section of fixture nearest the cord.
- The striped pair connects the 4 foot section furthest from the cord.
- Connect the pairs to the appropriate driver circuit (for 2 circuit module, solid pair is circuit 2, striped pair is circuit 1).
- If driver enclosure has only one pair of output wires, connect all red wires together (3) and all blue wires together (3).

For PF3: Independent Up | Dn Lighting Control: 4 conductor cords have a red + blue stripe pair and a red + blue solid pair – ensure the pairs are maintained in junction box connections.

- The solid pair connects to the direct lighting section of fixture (down).
- The striped pair connects to the indirect lighting section of the fixture (up).
- Connect the pairs to the appropriate driver circuit (solid pair is circuit 2 downlight, striped pair is circuit 1 uplight).

For Dynamic White 4 foot: The cord has 4 conductors; red + blue stripe pair and red + blue solid color pair. Ensure the pairs are maintained in the junction box connections.

- The solid color pair connects to the cool color LEDs
- The striped color pair connects to the warm color LEDs

For Dynamic White 6 foot and 8 foot: The cord has 8 conductors; red + blue stripe pair, red + blue solid color pair, orange + brown stripe pair, and orange + brown solid color pair. Ensure the pairs are maintained in the junction box connections.

- The solid color pairs connect to the cool color LEDs
- The striped color pairs connect to the warm color LEDs
- The red + blue pairs connect to the 4 foot section of the fixture nearest the cord
- The orange + brown pairs connect to the 2 or 4 foot section of the fixture furthest from the cord
- If the driver enclosure has only red + blue pairs of output wires, the lumen option only requires one LED driver. Connect the following fixture cord wire colors together to create 2 pairs; one solid color pair and one striped color pair:
 - red/orange solid color (positive) and blue/brown solid color (negative)
 - red/orange striped color (positive) and blue/brown striped color (negative)

12A | T-BAR APPLICATIONS: CLOSE WIRING LID

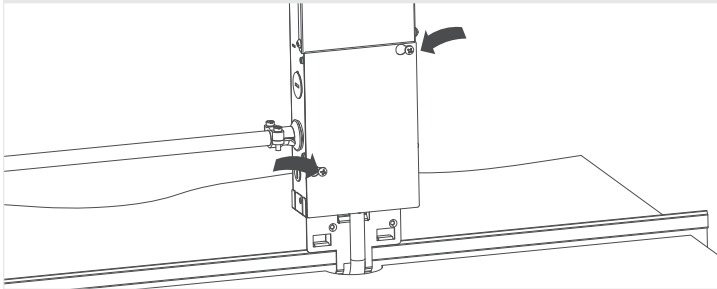

For T-bar ceilings: Close the wiring lid.

12B | DRYWALL APPLICATIONS: INSTALL CANOPY

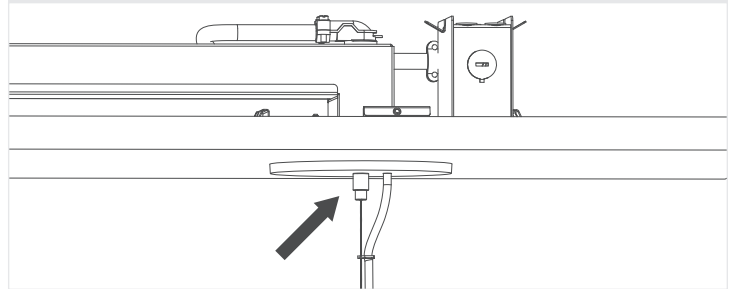

For drywall ceilings: Lift the canopy into place and tighten the sleeve.

12C | SURFACE APPLICATIONS: INSTALL COVER ASSEMBLY

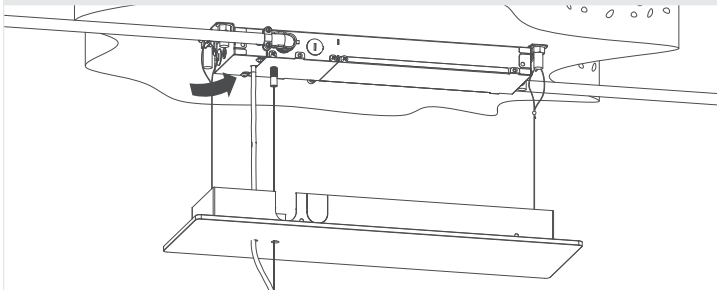

For surface mount: Close the low voltage wiring lid, install the cover assembly into place, and tighten the sleeve.

13 | SECURE CORD + APPLY POWER

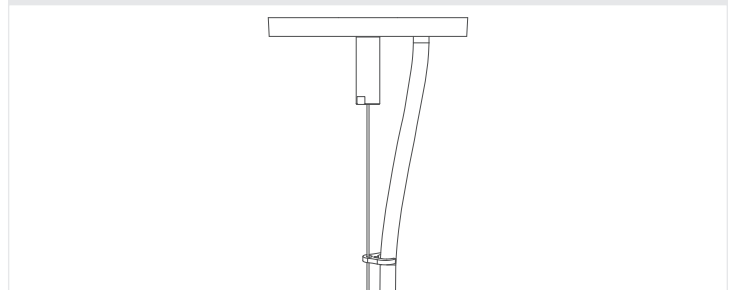

1. Stretch the cord up and reset the cord clips to hold the cord in line with the aircraft cable.
2. Apply power to the driver circuit(s).

14 | REMOVE BAG LATER

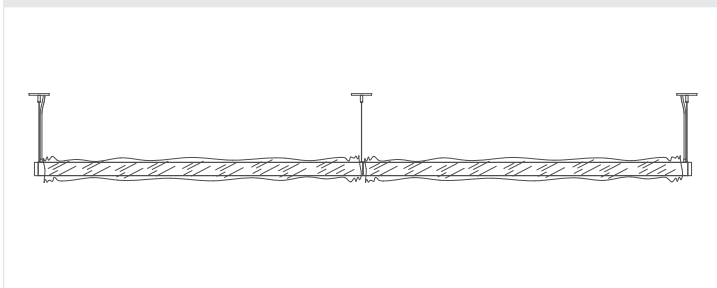

1. Leave the protective bag and care labels on the fixtures until construction and furniture are complete.
2. Fixture can be operated as normal with the bag on.
3. Tear bag at perforation, do not use knives or tools.

15 | ADJUST JOINT STRAIGHTNESS (IF REQUIRED)

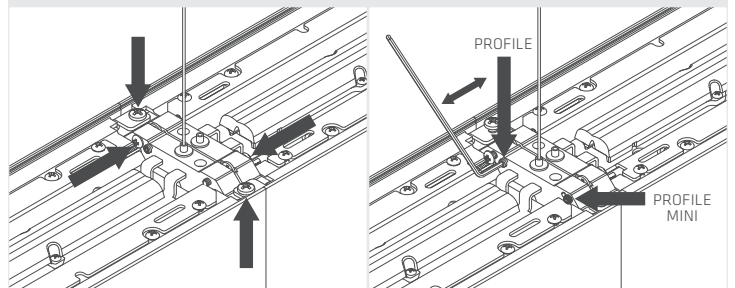

To straighten a joint after the run is installed, a set screw can be adjusted to apply pressure on one side of a joint location:

1. Partially loosen all 4 joining screws.
2. Tighten the set screw on the side that needs to open to straighten the row (using 1/16" Allen Key). The set screw will push that side of the joint apart to align the row.
3. Retighten the joining screws.